

LABEQUIM, S.A DE C.V



ProgRes[®] C3 CCD Routine Camera

Image sensor	1/1.8" CCD	Voltage supply	FireWire powered
Color / Monochrome	Color	Power consumption	approx. 6 W
Sensor resolution [max]	2080 x 1542 pixel [3.2 Mpix]	Ambient conditions	Temperature: +5 °C ... +35 °C, Humidity: 5 % ... 80 %, non condensing
Active sensor size [H x V]	7.58 mm x 6.54 mm	Storage conditions	Temperature: -10 °C ... +50 °C
Pixel size [W x H]	3.45 µm x 3.45 µm	Dimensions [L x W x H]	89 mm x 84 mm x 93 mm
A / D conversion	12 bit	Weight	approx. 700 g
Pixel clock	12 MHz	Application software	ProgRes [®] CapturePro for PC/ MAC (TWAIN for PC only)
Dynamic range	61 dB	SDK	ProgRes [®] SDK for PC, LINUX, MAC
Exposure times	270 µs ... 180 s	External camera driver	available at: www.jenoptik.com/progres
Analog gain	1x ... 12x (SDK)	Hardware requirements	PC: MS WIN XP/ Vista /WIN 7 Mac: OS X 10.4 or higher, 3 GHz CPU, 1 GB RAM, 256 MB graphics, FireWire a, Multicore recommended
Max. frame rate [image size]	6 fps [2080 x 1542 pixel] 12 fps [1040 x 770 pixel]		
Image resolution	Binning: 2x ... 5x (SDK) Progr. scan: 692 x 516 pixel		
Cooling	optional		
Digital interface	FireWire a		
Optical connection	C-Mount (0.5x or 0.63x TV pref., depends from the type of microscope)		
Trigger In / Out	no		

It is our policy to constantly improve the design and specifications. Accordingly, the details represented herein cannot be regarded as final and binding.

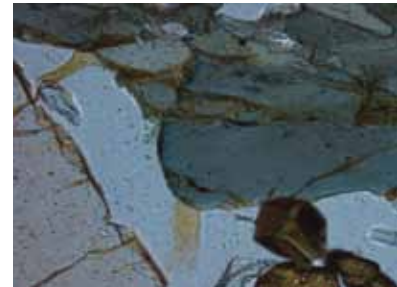
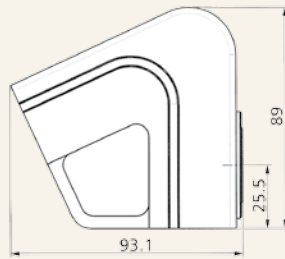
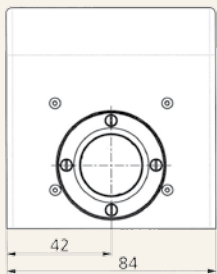

LABEQUIM, S.A DE C.V

LABEQUIM, S.A. DE C.V.

labequim.com.mx

ventas@labequim.com.mx

TEL/FAX: 01 (222) 219 8815, 274 5072, 274 5073

25 ote. #217 San Pedro Cholula, Puebla, Pue; Col. San Pedro Mexicaltzingo